

KOYO BLF205-15 bearing units

Bearing No. BLF205-15

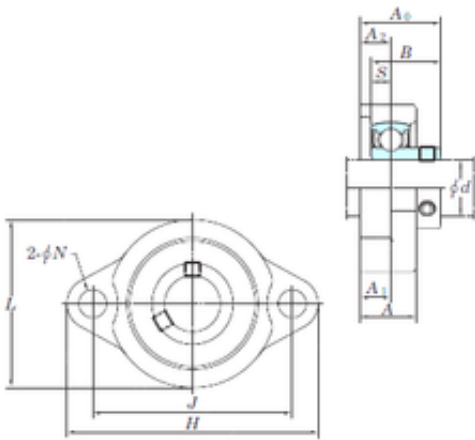

BLF205-15 Bearing 2D drawings and 3D CAD models

Bore Diameter	23,8125 mm
d	23,8125 mm
A0	30,5 mm
A	20 mm
A1	11 mm
B	27 mm
H	95 mm
J	76 mm
L	64 mm
N	10 mm
S	7,5 mm
Bolt (G)	M8
A2	11 mm
Weight	0,38 Kg
Basic dynamic load rating (C)	14 kN
Basic static load rating (C0)	7,85 kN