

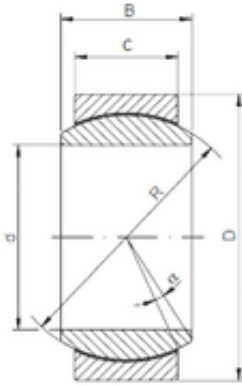

NTN DRIVESHAFT ANDERIU, INC.

280 mm x 400 mm x 155 mm ISO GE 280
ECR-2RS plain bearings



Bearing No. GE 280 ECR-2RS

Size	280x400x155 mm
Bore Diameter	280 mm
Outer Diameter	400 mm
Width	155 mm
d	280 mm
D	400 mm
B	155 mm
C	120 mm
R	350 mm
Angle	6 °

GE 280 ECR-2RS Bearing 2D drawings and 3D CAD models